

Installation Guide

Industrial\commercial

Roof

Metal\Asbestos\PVC

Trusses: Metal\Wood

Retrofit

DIY – Do It Yourself Ready



Tools: Cutting knife, measuring roll, staple gun + 12mm pins, Driller or electric screwdriver.

Installation Accessories: wooden strips or metal C shape strips, self tapping screws, Polynum or equivalent joints sealing tape.

Recommended to use protective glasses.

Products range: All Polynum™ products.

General: Polynum™ insulation can be easily installed under existing roof, using a supporting wooden or metal frame. The use of wooden frame will allow faster and easier installation process.

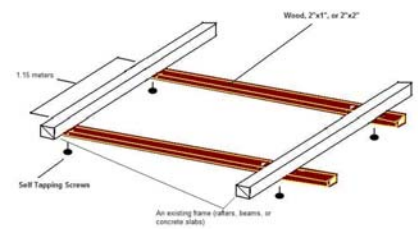

Step 1: Fix wooden strips or, C shape strips into an existing wood or metal trusses. Use at least 2" (50mm) x 1" (25mm) wood strips or C shape lines. Place the wood/metal strips 1.15m to 1.17m apart. Use metal wire, or, screws to fix the wood strips into the trusses. Use self-tapping screws, to fix the C shape lines, onto the trusses.

Step 2: With a measuring roll, measure the ceiling length. Unwrap Polynum insulation from its original packaging. Using cutting-knife, cut the Polynum at the desired length (prepare Polynum "shreds" per the required length). Allow 15cm (6 inches) for edge overlapping at the end of each piece. (Example: If ceiling length is 7.00m, and width is 4.00m you will need to cut 4x Polynum shreds, 7.30m (approx 21 feet long each).



Step 3: Starting from the edge, secure Polynum to pre-installed wood or metal strips (leave 10 to 15cm (4 to 6 inches) of extra "tail" (figure 3a) to be cut later, when work is completed). Move along the pre-installed strips, fixing Polynum with staple pins (if using wooden strips) or self tapping screws (if using C shape metal lines) See 3b illustration. Allow 15cm (6 inches) interval between each fixing point. Make sure to stretch the Polynum shreds to avoid sagging.

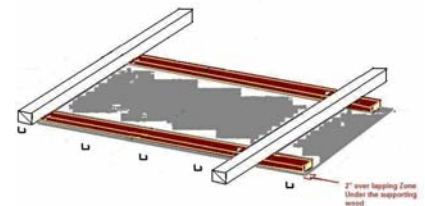

Step 4: Upon finishing fixing the first Polynum shred continue with the second (parallel) shred. Follow step 3. If using **self adhesive** product: upon proceeding, secure the joints (over-lapping) with Polynum self-adhesive strips. When using Polynum **without self-adhesive**: When fixing the shred onto the strips (lines) with already installed Polynum, 50mm (2 inches) of overlapping is required (the distance between the pre-installed strips\lines is less than Polynum width). See illustration 4a. Use staple pins or self tapping screws to secure the overlapping joints. Ensure to staple both Polynum joints together. Upon finishing each shred, use Polynum all weather heavy duty closing tape to seal the joints.

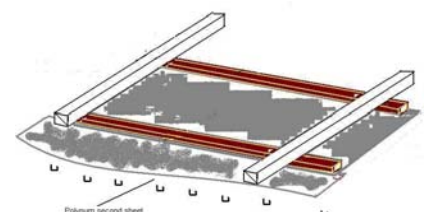
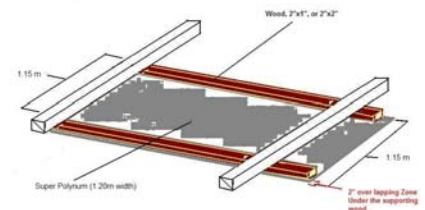

3a



Guide for overlapping joints:

4a

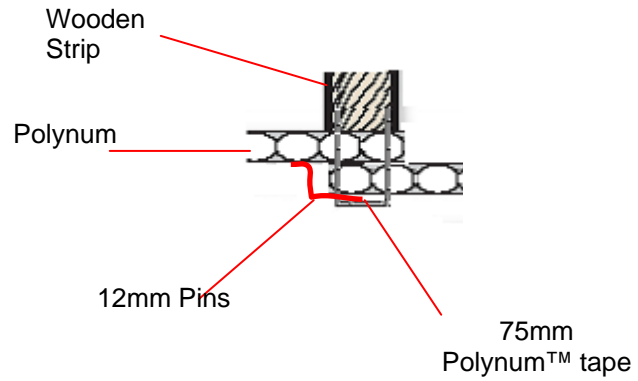

3b

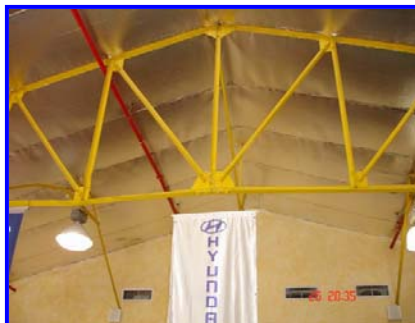
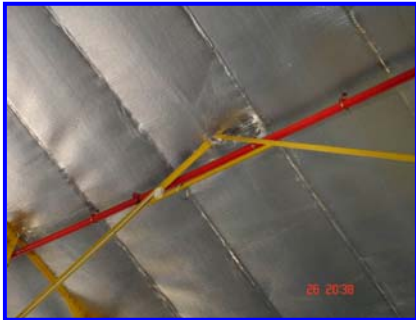

- Polynum™ installation process is clean, fast and efficient
- Polynum™ required less labor and less time covering similar area compare with bulk insulation
- Polynum™ can be installed anywhere in the buildings.
- Polynum™ only required measuring tape, cutting knife, ducting tape and pair of hands...
- Polynum™ can be left exposed for the installation duration. No need extra cover or handling.
- Polynum™ can be shaped and cut to size, reduced wastage!
- Polynum™ requires no gloves or special protection aids.
- There are almost no limitations to where Polynum™ can be used